

REVISIONS	BY

PACIFIC MODERN HOMES
P.O. BOX 670
ELK GROVE, CA.
95759
PHONE: (916) 685-9514

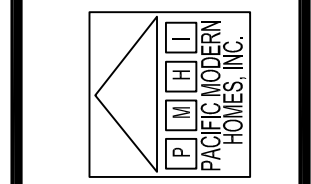

FLOOR PLAN

RESIDENCE FOR:

PRE-ENGINEERED
MAYWOOD

DATE:	5/8/15
SCALE:	1/4" = 1'-0"
DRAWN BY:	
PLAN NO.:	
SHEET:	2

SQUARE FOOTAGE:

FLOOR PLAN	600 SQ FT
COVERED PORCH	108 SQ FT

HEADERS FOR 2X6 WALLS UNLESS OTHERWISE NOTED:

OPENING	HEADER	TRIMMER	KING STUDS
0'-0" TO 6'-0"	6X12 #1 DF	SINGLE 2X	SINGLE 2X
OVER 6'-0" TO 8'-0"	6X12 #1 DF	DOUBLE 2X	DOUBLE 2X

HEADERS FOR 2X4 WALLS UNLESS OTHERWISE NOTED:

OPENING	HEADER	TRIMMER	KING STUDS
0'-0" TO 6'-0"	4X12 #2 DF	SINGLE 2X	SINGLE 2X
OVER 6'-0" TO 8'-0"	4X12 #2 DF	DOUBLE 2X	DOUBLE 2X

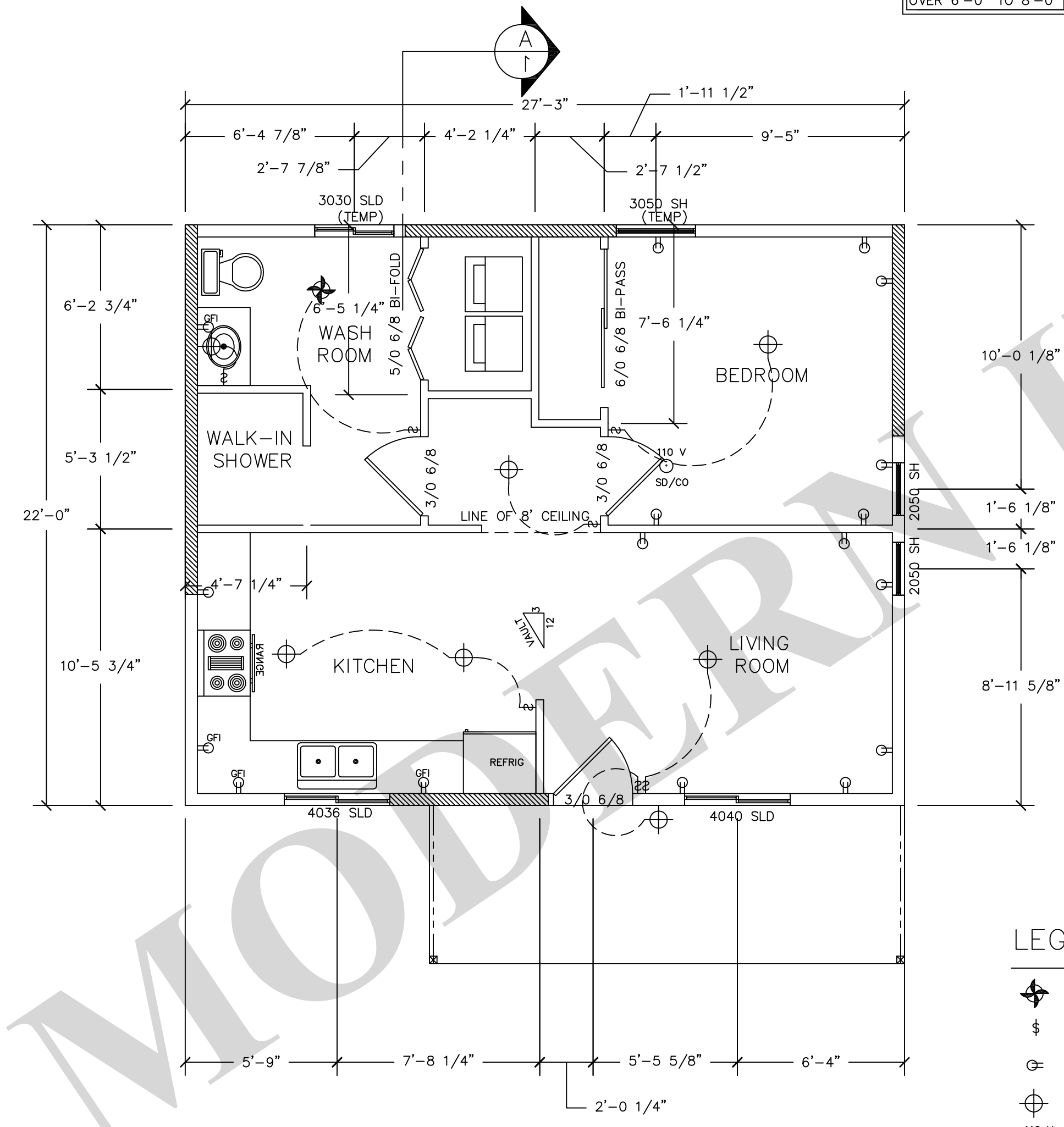

KEY NOTES:

- NON-REMOVEABLE ANTI-SIPHON DEVICES ARE REQUIRED AT ALL HOSE BIBS. THIS IS TO PREVENT THE POSSIBLE BACKFLOW OF CONTAMINATED WATER INTO THE POTABLE WATER SYSTEM.
- LANDING AT DOORS SHALL BE A MINIMUM OF THE WIDTH OF THE DOOR, AND EXTEND IN THE DIRECTION OF TRAVEL A MIN OF 36". LANDINGS OUTSIDE ALL EXTERIOR DOORS NOT TO BE MORE THAN 7-3/4 IN LOWER THAN THE THRESHOLD FOR IN-SWING DOORS.
- PLUMBING FIXTURES AND PLUMBING FITTINGS SHALL MEET THE FOLLOWING STANDARDS:
LAVATORY FAUCETS 1.5 GPM @ 60 PSI (MAX)
KITCHEN FAUCETS 0.8 GPM @ 20 PSI (MIN)
WATER CLOSETS 1.8 GPM @ 60 PSI
SHOWER HEADS 1.28 GAL/FLUSH
2.0 GPM @ 80 PSI
- EXHAUST FANS ARE REQUIRED IN ALL BATHROOMS AND KITCHENS. FOLLOWING STANDARDS:
EXHAUST FANS IN BATHROOMS SHALL BE MIN. 50cfm.
EXHAUST FANS IN KITCHENS SHALL BE MIN. 100 cfm.
EXHAUST FANS IN KITCHEN AND BATHROOMS SHALL BE DUCTED TO THE OUTSIDE.
- SHOWER AND/OR TUB-SHOWER COMBINATIONS ARE TO BE PROVIDED WITH INDIVIDUAL CONTROL VALVES OF THE PRESSURE BALANCE OR THE THERMOSTATIC MIXING VALVE TYPE. THE WATER TEMPERATURE MAXIMUM IS A SETTING OF 120 DEGREES F.
SHOWER WALLS SHALL BE FINISHED WITH A SMOOTH, HARD, NON-ABSORBENT SURFACE TO A HEIGHT NOT LESS THAN 72" ABOVE THE DRAIN INLET.
- SMOKE AND CARBON MONOXIDE COMBO DETECTORS (KIDDLE MODEL #21008046 OR SIMILAR) SHALL RECEIVE THEIR PRIMARY POWER FROM THE BUILDING WIRING AND SHALL BE EQUIPPED WITH A BATTERY BACKUP. THE ALARM SHALL BE AUDIBLE IN ALL SLEEPING AREAS OF THE DWELLING, AND ALL SMOKE/CARBON MONOXIDE DETECTORS SHALL BE INTERCONNECTED IN A MANNER THAT THE ACTIVATION OF ONE WILL ACTIVATE ALL. ALARMS SHALL BE INSTALLED IN EACH SLEEPING ROOM, OUTSIDE EACH SEPARATE SLEEPING AREA IN THE IMMEDIATE VICINITY OF THE BEDROOMS PER CRC 314.3. ALARMS SHALL BE LISTED AS COMPLYING WITH UL 2034 & UL 2075.
- CONTINUOUS OPERATING BATH FAN TO COMPLY WITH WHOLE HOUSE VENTILATION. SHALL BE LABELED TO STATE "FAN SHOULD BE ON WHENEVER THE HOME IS OCCUPIED", WITH A MINIMUM 60 CFM WITH A FOUR(4) INCH DUCT. FAN MUST BE LISTED AT ONE(1) SONE OR LESS. HOME DEPOT MODEL #QTRN080 OR SIMILAR.

LEGEND

- FAN LIGHT
- SWITCH
- RECEPTACLE
- LIGHT
- SMOKE/CARBON MONOXIDE ALARM
- HOSE BIB
- DIM DIMMER SWITCH
- OCCUPANCY SENSOR
- FLUORESCENT LIGHTING

PACIFIC MODERN HOMES, INC.