

PACIFIC MODERN HOMES

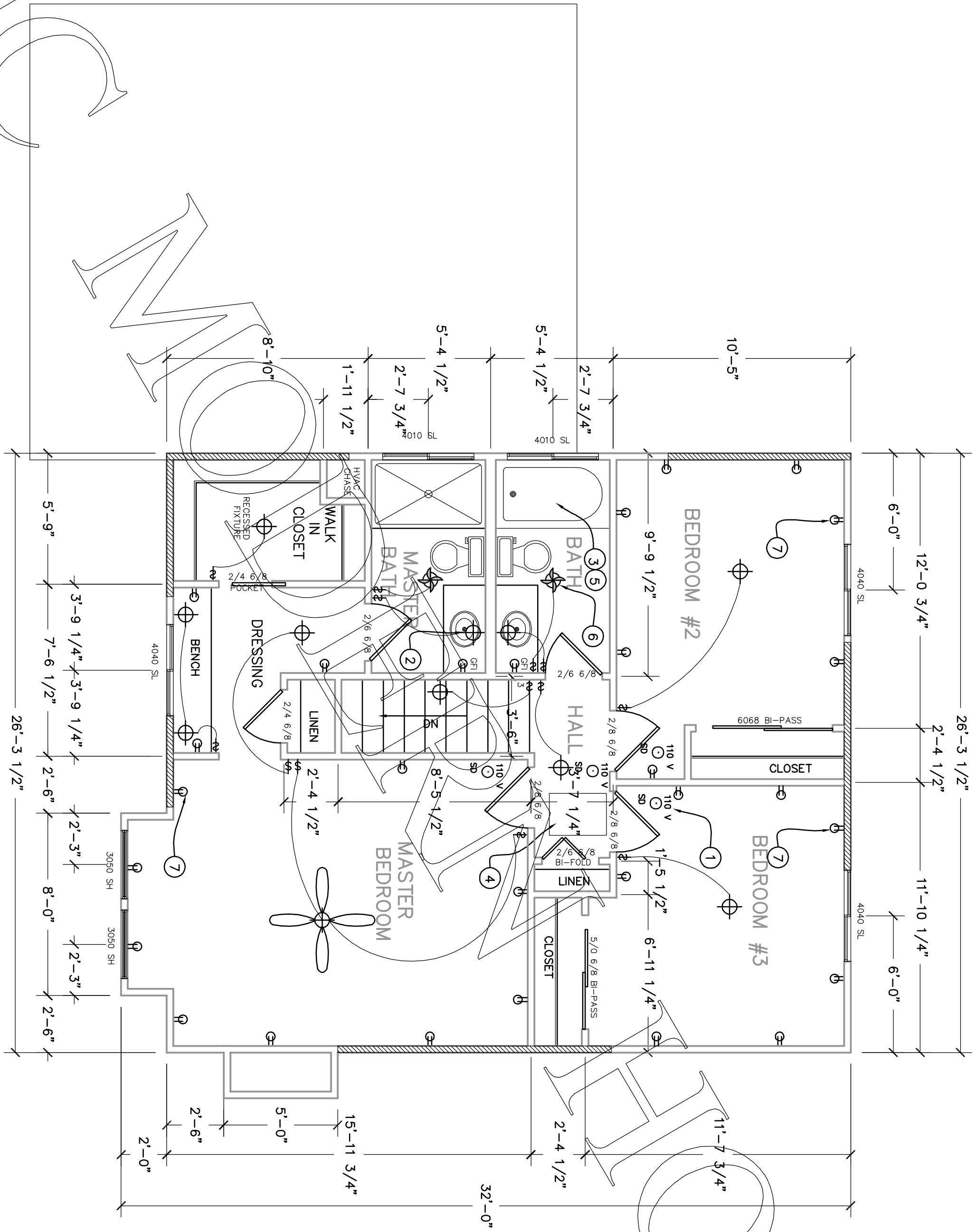

SECOND FLOOR PLAN

SCALE 1/4" = 1'-0"

KEY NOTES:

1. SMOKE DETECTORS SHALL RECEIVE THEIR PRIMARY POWER FROM THE BUILDING WIRING AND SHALL BE INSTALLED IN ALL SLEEPING AREAS OF THE DWELLING. ALL SMOKE DETECTORS SHALL BE INTERCONNECTED.
2. FULL BATH MUST HAVE AT LEAST ONE LUMINAIRE WITH LAMPS WITH AN EFFICACY OF AT LEAST 40 LUMENS PER WATT.
3. SHOWER AND/OR TUB-SHOWER COMBINATIONS ARE TO BE PROVIDED WITH INDIVIDUAL CONTROL VALVES OF THE PRESSURE BALANCE OR THE THERMOSTATIC MIXING VALVE TYPE. THE WATER TEMPERATURE MAXIMUM IS A SETTING OR 120° F.
4. A 22" X 30" ATTIC ACCESS IS REQUIRED FOR THE ATTIC ACCESS NEEDS TO BE IN AN ACCESSIBLE LOCATION AND IS NOT TO BE LOCATED ABOVE A CLOSET SHELF OR POLE 30" MINIMUM HEADROOM IS REQUIRED ABOVE THE ACCESS. ATTICS WITH EQUIPMENT NEED A 20" X 30" ACCESS. ATTIC ACCESS SHALL BE PROVIDED WITH TRUSSES ARE USED. PROVIDED THE LARGEST PIECE OF EQUIPMENT CAN BE REMOVED THROUGH THE OPENING.
5. SHOWER AND TUB/SHOWER WALLS SHALL BE FINISHED WITH A HAND, NON-ABSORBENT SURFACE TO A HEIGHT OF NOT LESS THAN 70" ABOVE THE DRAIN INLET. THE FLOOR AREA OF A SHOWER NEEDS TO BE AT LEAST 1024 SQ IN. WITH A MINIMUM DIMENSION OF 30".
6. MECHANICAL VENTILATION SYSTEM CAPABLE OF PROVIDING FIVE AIR CHANGES PER HOUR.
7. ALL RECEPTACLE OUTLETS INSTALLED IN BEDROOMS TO BE PROTECTED BY AN ARC-FAULT CIRCUIT INTERRUPTER.

LEGEND

- ⌘ SWITCH
- ⊕ RECEPTACLE
- ⊙ LIGHT
- ⊙ SMOKE DETECTOR
- ⊙ FAN LIGHT