

LEGEND

1. SWITCH
2. RECEPTACLE
3. LIGHT
4. SMOKE DETECTOR
5. FAN LIGHT

KEY NOTES:

1. SMOKE DETECTORS SHALL RECEIVE THEIR PRIMARY POWER FROM THE BUILDING WIRING AND SHALL BE EQUIPPED WITH A BATTERY BACKUP. THE ALARM SHALL BE AUDIBLE IN ALL SLEEPING AREAS OF THE INTERCONNECTED. ALL SMOKE DETECTORS SHALL BE INTERCONNECTED.
2. FULL BATH MUST HAVE AT LEAST ONE LUMINAIRE PER WATT AN EFFICACY OF AT LEAST 40 LUMENS PER WATT.
3. SHOWER AND/OR TUB-SHOWER COMBINATIONS ARE TO BE PROVIDED WITH AN AUTOMATIC SHUT-OFF OF THE PRESSURE BALANCE OR THE THERMOSTATIC MIXING VALVE TYPE. THE WATER TEMPERATURE MAXIMUM IS A SETTING OR 120 F.
4. A 22" X 30" ATTIC ACCESS IS REQUIRED FOR ALL ATTICS WHICH ARE MORE THAN 30" IN HEIGHT. THE LOCATION AND IS NOT TO BE LOCATED ABOVE A SLEEPING AREA. THE ACCESS SHALL BE REMOVED ABOVE THE ACCESS. ATTICS WITH EQUIPMENT NEED A 30" X 30" ACCESS. EXCEPTIONS: THE ACCESS MAY BE 22" X 30" WHEN TRUSSES ARE USED, PROVIDED THE LARGEST PIECE OF EQUIPMENT CAN BE REMOVED THROUGH THE OPENING.
5. SHOWER WALLS SHALL BE FINISHED WITH A HARD, NON-ABSORBENT SURFACE TO A HEIGHT NOT LESS THAN 2' ABOVE THE SHOWER FLOOR.
6. MECHANICAL VENTILATION SYSTEM CAPABLE OF PROVIDING FIVE AIR CHANGES PER HOUR.
7. 42" HIGH RAILING WITH NO OPENING LARGE ENOUGH FOR A 4" SPHERE TO PASS THROUGH.
8. COPE COMPLYING HANDRAIL 34" - 38" ABOVE NOSE OF TREAD, SEE DETAIL 1-3.
9. ALL RECEPTACLE OUTLETS INSTALLED IN BEDROOMS SHALL BE PROTECTED BY AN ARC-FAULT CIRCUIT INTERRUPTER.
10. PLUMBING FIXTURES AND PLUMBING FITTINGS SHALL COMPLY WITH THE FOLLOWING: SINKS: 2.2 GPM MAX LAVATORY AND SINK FAUCETS 1.5 GAL/FLUSH MAX SHOWER HEADS 2.5 GPM MAX
11. FLUSH MOUNT, FULLY ENCLOSED INCANDESCENT LIGHT.

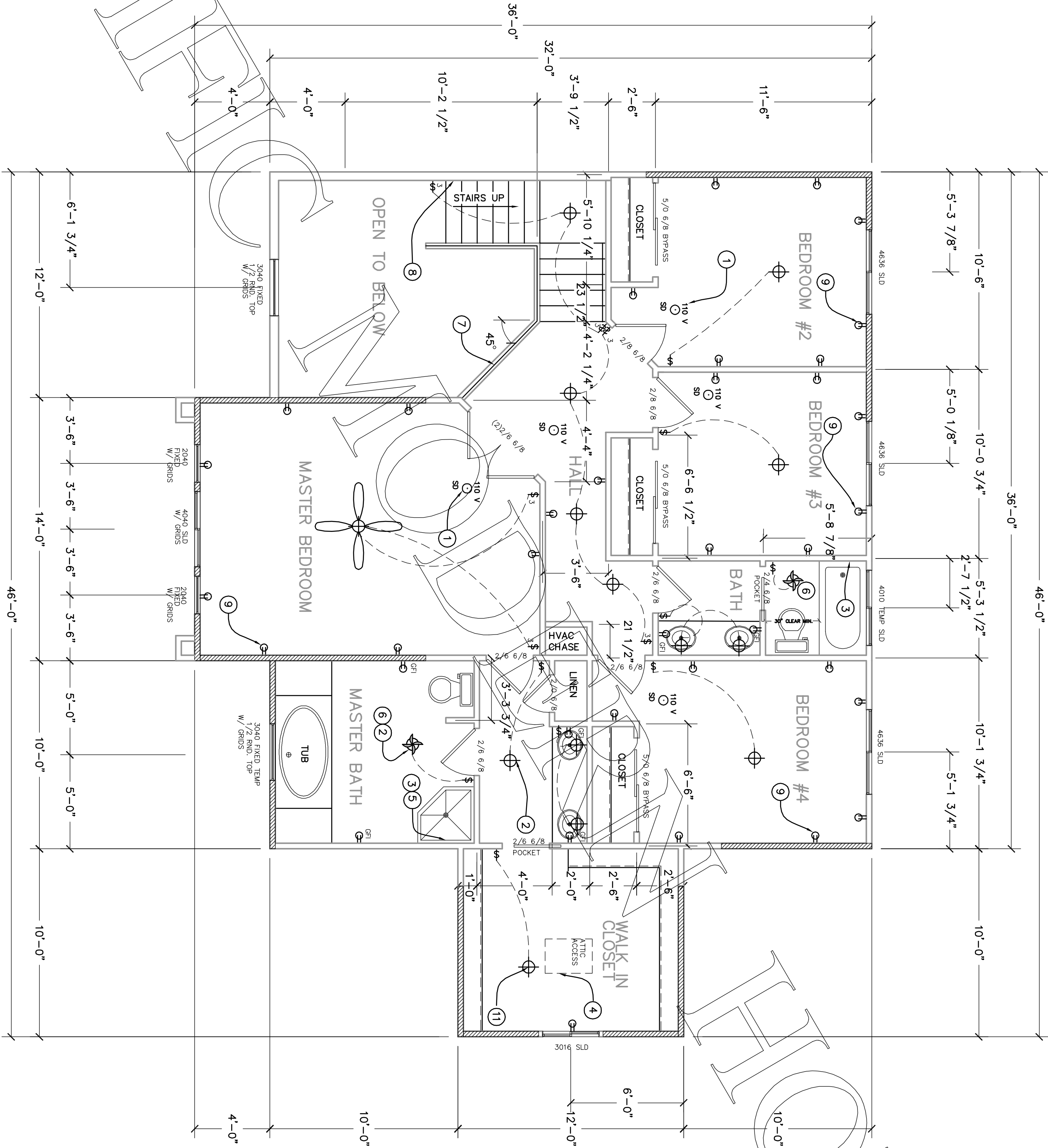

SECOND FLOOR PLAN

SCALE 1/4" = 1'-0"

REVISIONS BY

DATE

DESCRIPTION

BY

DATE

PACIFIC MODERN HOMES
P.O. BOX 670
ELK GROVE, CA.
95759-9514
PHONE: (916) 685-9514



SECOND FLOOR PLAN

RESIDENCE FOR:

PRE-
ENGINEERED
SPRINGFIELD

DATE

SCALE: 1/4" = 1'-0"

TOWN OF

TOWN OF

SHEET: 4