

LEGEND

- Ⓢ SWITCH
- Ⓡ RECEPTACLE
- Ⓛ LIGHT
- Ⓜ SMOKE DETECTOR
- Ⓜ HOSE BIB

FLOOR PLAN KEY NOTES:

1. SMOKE DETECTORS SHALL RECEIVE THEIR PRIMARY POWER FROM THE BUILDING WIRING AND SHALL BE EQUIPPED WITH A BATTERY BACKUP. THE ALARM SHALL BE AUDIBLE IN ALL SLEEPING AREAS OF THE HOME. ALL SMOKE DETECTORS SHALL BE INTERCONNECTED.
2. KITCHEN LIGHTING TO HAVE AN EFFICACY OF AT LEAST 100 LUMENS PER WATT. ALL ACCESSIBLE SWITCH(ES) IN THE KITCHEN.
3. HALL LIGHTS MUST HAVE AT LEAST ONE LUMINAIRE WITH LUMENS PER WATT. I.E. FLUORESCENT.
4. SHOWER AND/OR TUB-SHOWER COMBINATIONS ARE TO BE PROVIDED WITH INDIVIDUAL CONTROL VALVES OF THE PRESSURE BALANCE OR THE THERMOSTATIC MIXING VALVE TYPE. THE WATER TEMPERATURE SHALL BE MAINTAINED WITHIN 120°F. SHOWER WALLS SHALL BE FINISHED WITH 1/2" X 1/2" NON-ABSORBENT SURFACE TO A HEIGHT NOT LESS THAN 70" ABOVE THE DRAIN INLET.
5. WATER HEATER TO HAVE SEISMIC BRACING AS PER MANUFACTURERS INSTRUCTIONS OR STATE ARCHITECT OFFICE GUIDELINES. SEE DETAIL 2-0. ALL STORAGE TYPE WATER HEATERS NEED A REMPERATURE/RELIEF VALVE. THE VALVE SHALL BE INSTALLED ABOVE THE DRAIN WHICH TERMINATES 6" TO 24" ABOVE GRADE AND POINTING DOWNWARD. THE DRAIN PIPE SHALL MAINTAIN A DOWNWARD SLOPE TO THE EXTERIOR.
6. A 22" X 30" ATTIC ACCESS IS REQUIRED FOR ALL ATTICS WHICH ARE MORE THAN 30" IN HEIGHT. THE ATTIC ACCESS NEEDS TO BE IN AN ACCESSIBLE LOCATION AND IS NOT TO BE LOCATED ABOVE A ROOM OR ABOVE A ROOM WHICH IS ABOVE A ROOM. ACCESS ABOVE THE ACCESS ATTICS WITH EQUIPMENT NEED A 30" X 30" ACCESS. EXCEPTIONS: THE ACCESS MAY BE 22" X 30" WHEN TRUSSES ARE USED. PROVIDE THE LARGEST SIZE OF EQUIPMENT CAN BE REMOVED THROUGH THE OPENING.
7. THE CLOTHES DRYER EXHAUST DUCT IS LIMITED 14' TOTAL LENGTH INCLUDING ELBOWS. FROM THE DUCT TO THE EXTERIOR. PROVIDE A MIN. WORKING SPACE OF NOT LESS THAN 30" WIDE BY 36" DEEP AND 6'-6" HIGH.
8. ANTI-SIPHON DEVICES ARE REQUIRED AT ALL HOSE BIBBS. MIN ONE BACK AND ONE FRONT OF STRUCTURE. THIS IS TO PREVENT THE POSSIBLE BACKFLOW OF CONTAMINATED WATER INTO THE POTABLE WATER SYSTEM.
9. PLUMBING FIXTURES AND PLUMBING FITTINGS SHALL MEET THE FOLLOWING STANDARDS: 2.2 GPM MAX. WATER CLOSETS 1.6 GAL/FLUSH MAX. SHOWER HEADS 2.5 GPM MAX.
10. ALL RECEPTACLE OUTLETS INSTALLED IN BEDROOMS TO BE PROTECTED BY AN ARC-FAULT CIRCUIT INTERRUPTER.
11. 18 X 24 UNDER FLOOR ACCESS.

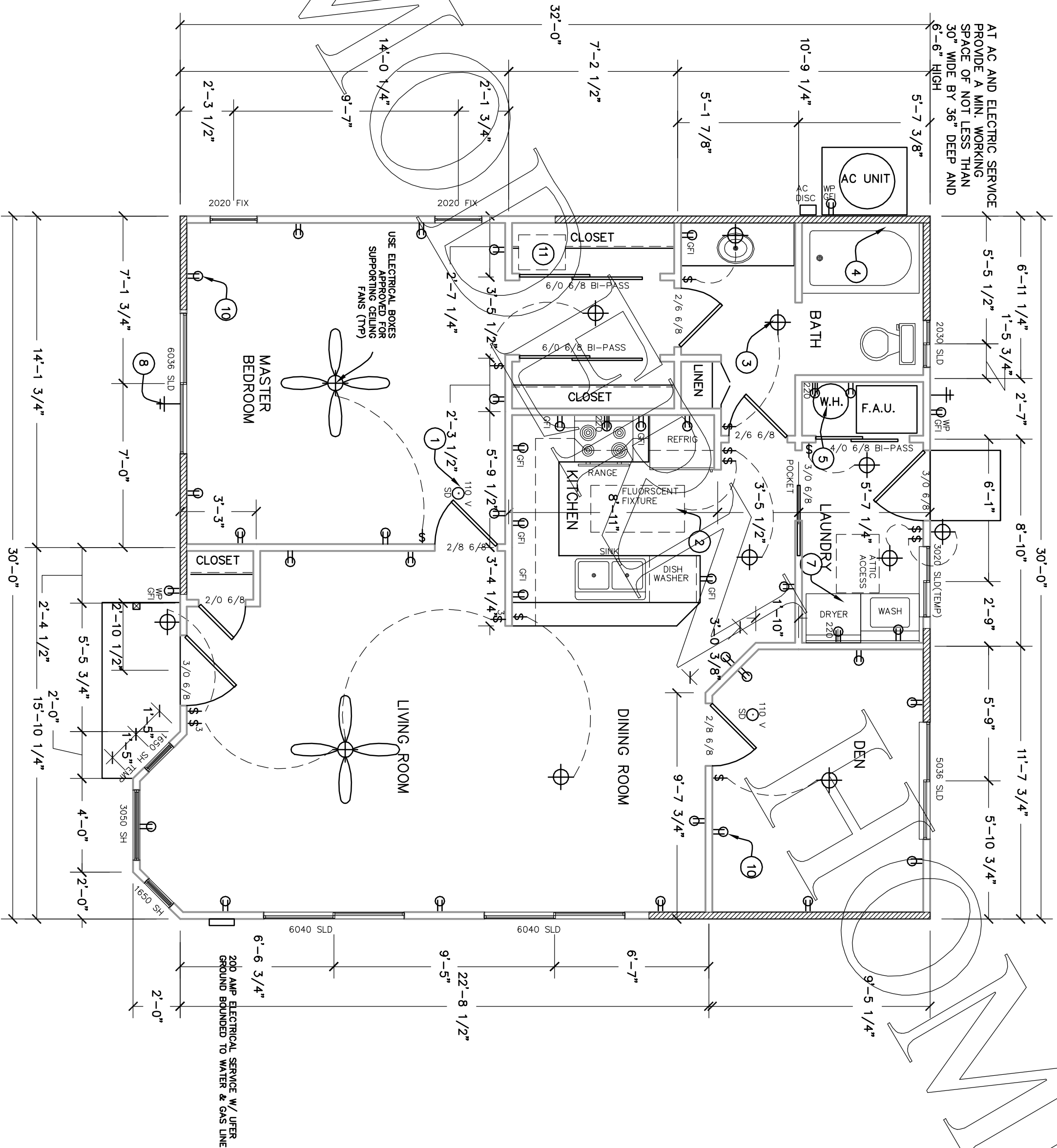

PACIFIC

FLOOR PLAN

SCALE 1/4" = 1'-0"

SQUARE FOOTAGE:

HOUSE	972 SQ FT
COVERED PORCH	23 SQ FT