

KEY NOTES:

1. SMOKE DETECTORS SHALL RECEIVE THEIR PRIMARY POWER FROM THE MAIN SERVICE PANEL. SMOKE DETECTORS SHALL BE EQUIPPED WITH A BATTERY BACKUP. THE ALARM SHALL BE AUDIBLE IN ALL SLEEPING AREAS OF THE DWELLING. ALL SMOKE DETECTORS SHALL BE INTERCONNECTED.
2. FULL BATH MUST HAVE AT LEAST ONE LUMINAIRE WITH LAMPS WITH AN EFFLUX OF AT LEAST 40 LUMENS PER WATT. I.E. FLUORESCENT.
3. ALL RECEPTACLE OUTLETS INSTALLED IN BEDROOMS TO BE PROTECTED BY AN ARC-FAULT CIRCUIT INTERRUPTER.
4. SHOWER AND/OR TUB-SHOWER COMBINATIONS ARE TO BE PROVIDED WITH INDIVIDUAL CONTROL VALVES OF THE PRESSURE BALANCE OR THE THERMOSTATIC MIXING VALVE TYPE. THE WATER TEMPERATURE MAXIMUM IS A SETTING OF 120 ° F
5. A 22" X 30" ATTIC ACCESS IS REQUIRED FOR ALL ATTICS WHICH ARE MORE THAN 30" IN HEIGHT. THE ATTIC ACCESS NEEDS TO BE IN AN ACCESSIBLE LOCATION AND IS NOT TO BE LOCATED ABOVE A CLOSET OR A BATH. A MINIMUM HEADROOM IS REQUIRED ABOVE THE ACCESS.
6. FLUSH MOUNT LIGHT IN WALK-IN CLOSET
7. CODE APPROVED HAND RAIL 34" - 38" ABOVE NOSE OF STAIRS. SEE DETAIL D-12
8. MECHANICAL DEVICE CAPABLE OF PROVIDING (5) FIVE AIR CHANGES PER HOUR

GENERAL NOTES:

1. PLUMBING FIXTURES AND PLUMBING FITTINGS SHALL MEET THE FOLLOWING STANDARDS:
SINKS AND SINK FAUCETS 2.2 GPM MAX
WATER CLOSETS 1.6 GAL/FLUSH MAX
SHOWER HEADS 2.5 GPM MAX
2. BATHROOM BRANCH CIRCUITS, IN ADDITION TO OTHER BRANCH CIRCUIT REQUIREMENTS, AT LEAST ONE 20 AMP BRANCH CIRCUIT SHALL BE REQUIRED TO SUPPLY BATHROOM RECEPTACLE OUTLETS. OTHER EQUIPMENT (LIGHTING, FANS), WITHIN THE SAME BATHROOM MAYBE SUPPLIED BY THE SAME BRANCH CIRCUIT WHERE THE BRANCH CIRCUIT SUPPLIES A SINGLE BATHROOM ONLY.

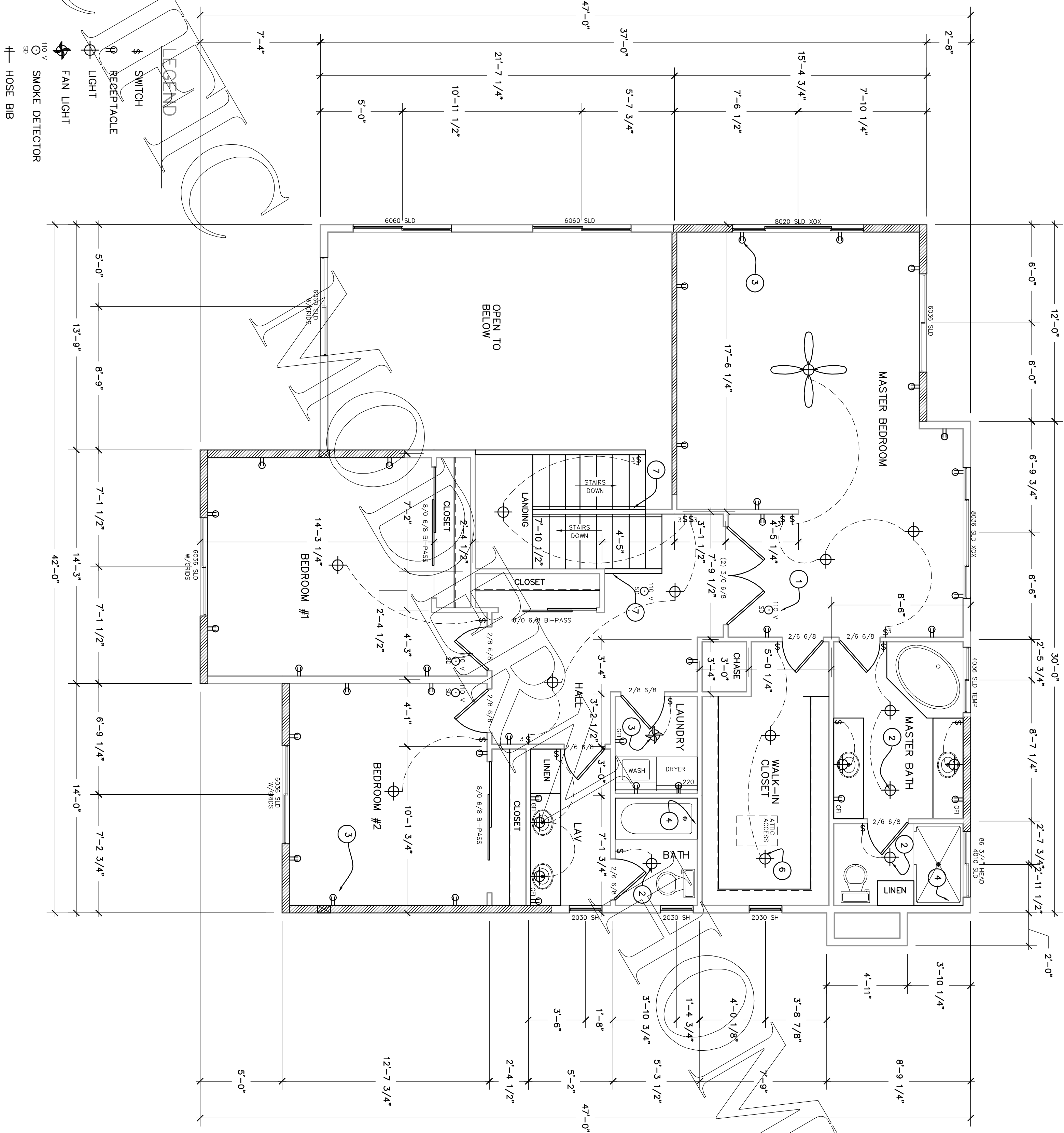

SECOND FLOOR PLAN

SCALE 1/4" = 1'-0"

REVISIONS BY

DATE

DESCRIPTION

BY

DATE

PACIFIC MODERN HOMES
P.O. BOX 670
ELK GROVE, CA.
95759-9514
PHONE: (916) 685-9514



PAGE TITLE

FLOOR PLAN

RESIDENCE FOR:

PRE-
ENGINEERED
EMERALD

DATE

SCALE
1/4" = 1'-0"

TOWN OF

TOWN OF

SHEET:

3